



# EcoEvolution<sup>TM</sup>



The logo for Ecolutions, featuring the word "Ecolutions" in a bold, black, sans-serif font with a green and blue gradient. The letter "o" is replaced by a stylized globe icon with a green and blue color scheme. A small trademark symbol (TM) is located to the upper right of the word.

**Ecolutions™**

# **Ecolutions Program**



# EcoEvolution<sup>™</sup>

- Cross Sectional Views
- 3.25" RR Frame with Optional Integral 1.5" Nail fin and J Channel
- All Fin configurations available (J, no J, Fin, NO Fin)
- Face accessory grooves with in excess of 50 accessory profiles
- Dedicated Head

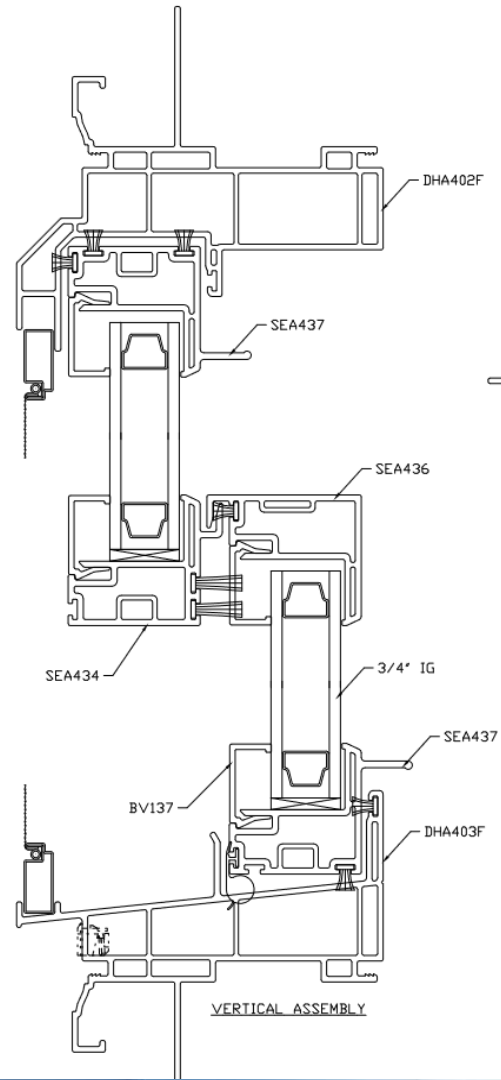



- Cross Sectional Views
- 3.25" RR Frame with Optional Integral 1.5" Nail fin and J Channel
- All Fin configurations available
- Face accessory grooves with in excess of 50 accessory profiles
- Dedicated Head

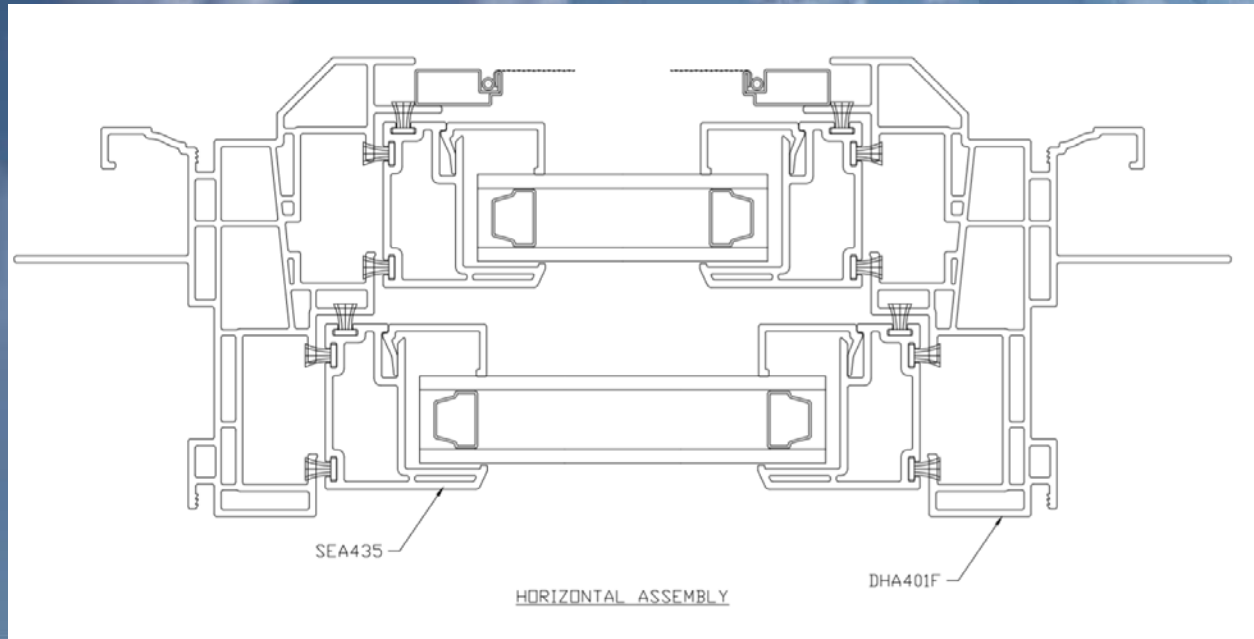

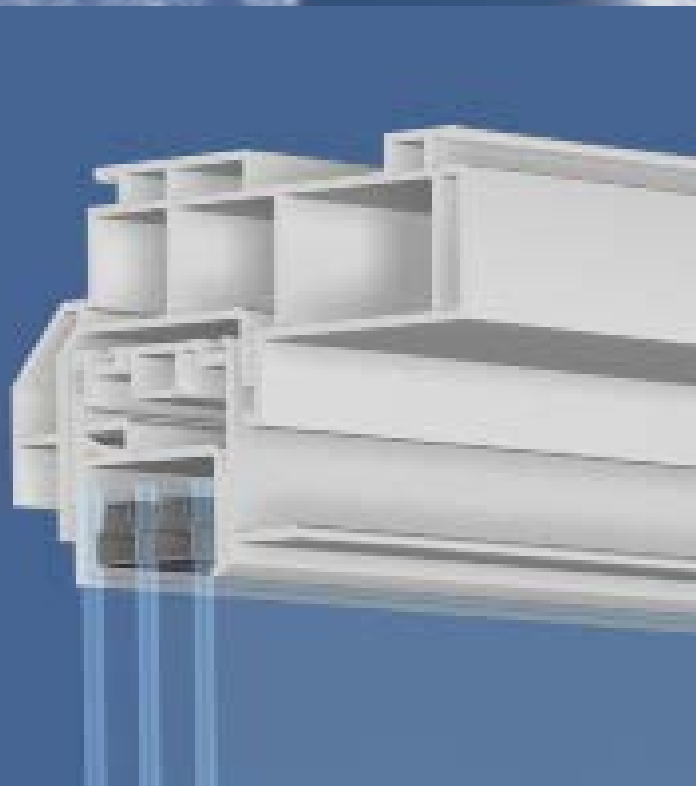

- **Head Detail**
- **Dedicated Head Profile**
- **Triple weather seal at the head**
- **Screen Track for 5/16" Screen**

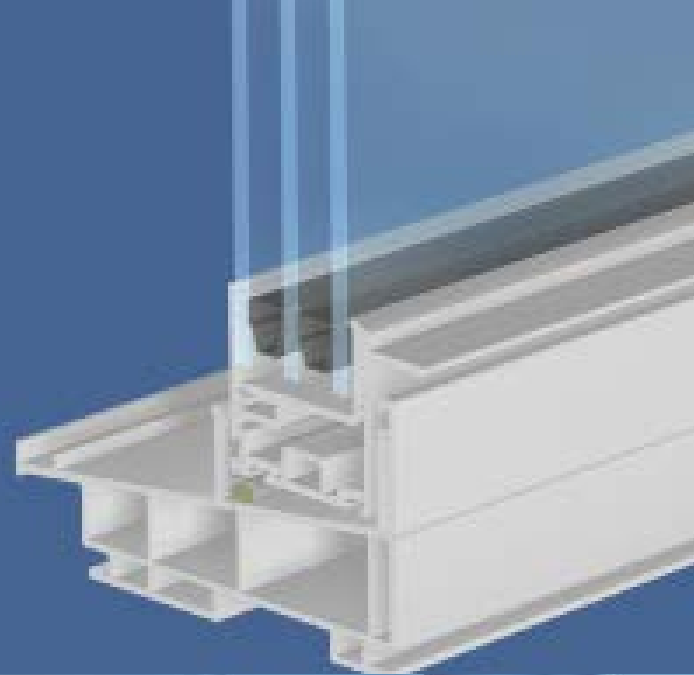

- Sill Detail
- Sill Up stand for improved Structural Performance (DP50), and Impact
- Triple weather seal at the Sill
- Wept Sloped Sill design



- Jamb Detail
- Unequal Glass Sightlines
- Triple weather seal at the Jamb
- Glazing from  $\frac{3}{4}$ " to 1-1/8"
- Screen Track for 5/16" Screen
- Unobtrusive exterior bevel even with 1-1/8' IG Capability
- Standard Balance Chambers to accept Block & Tackle, Constant, Force and Spiral

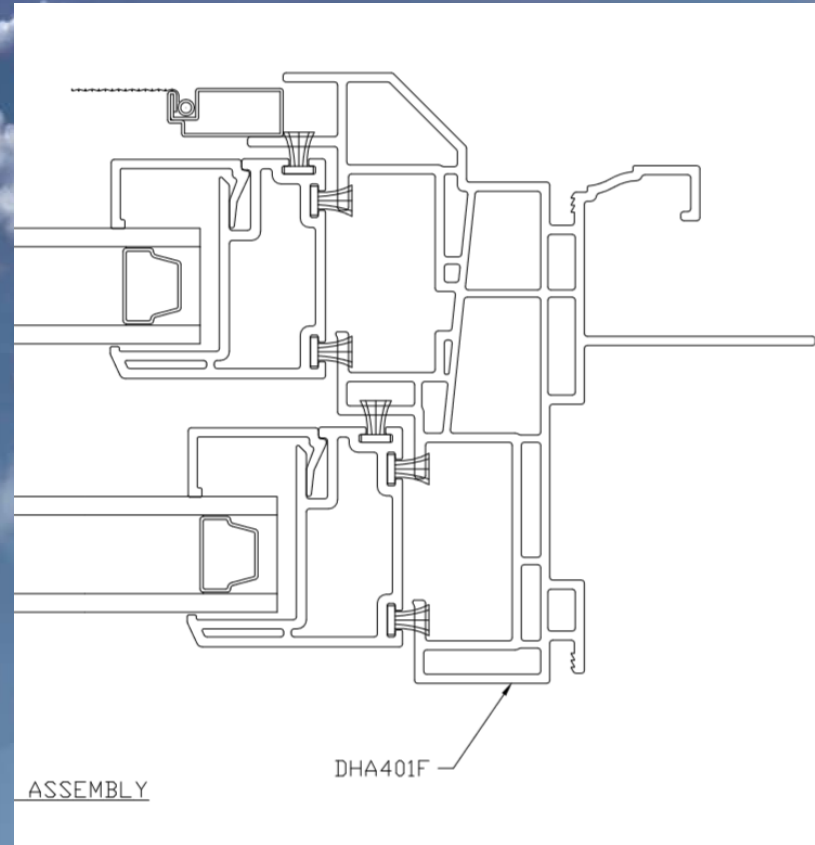



- **Horizontal Detail**
- Horizontal detail provides narrow sightlines while still allowing for larger IG pocket and Distinct bevel.

Design enhances egress opportunities

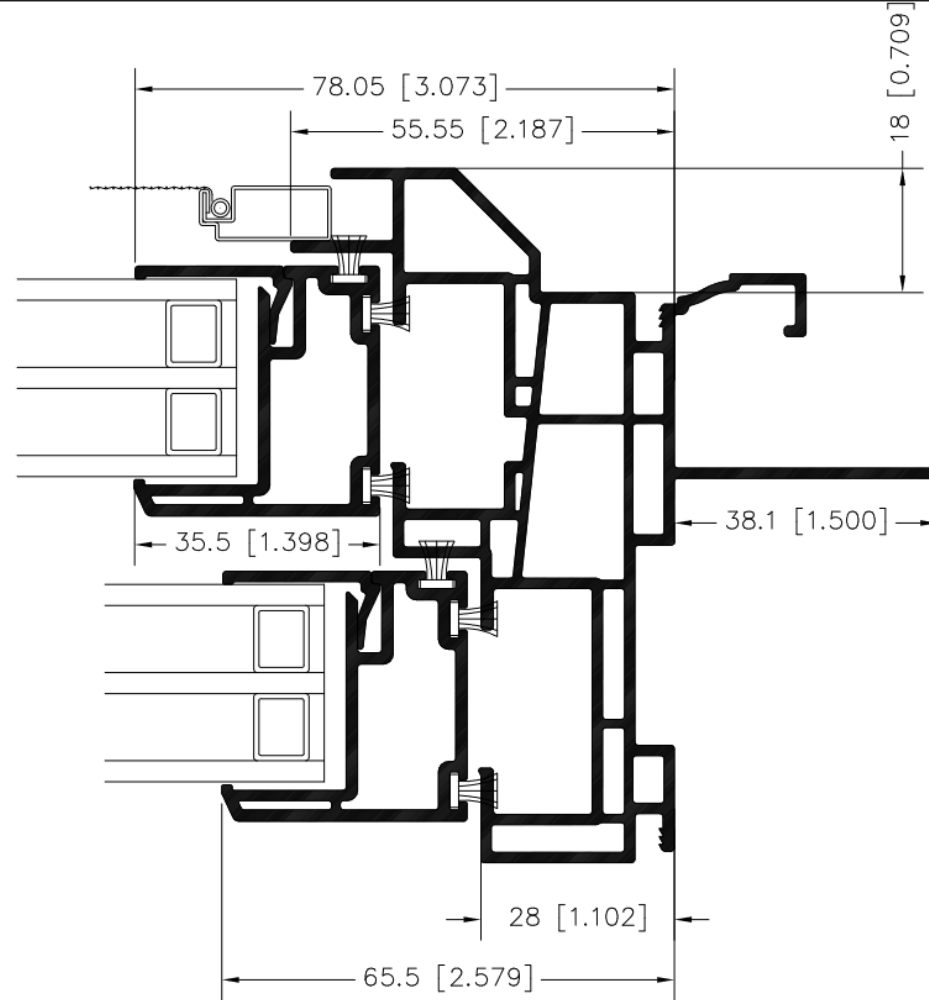





- **Horizontal Detail**
- Vertical detail provides narrow sightlines  
Design enhances egress opportunities

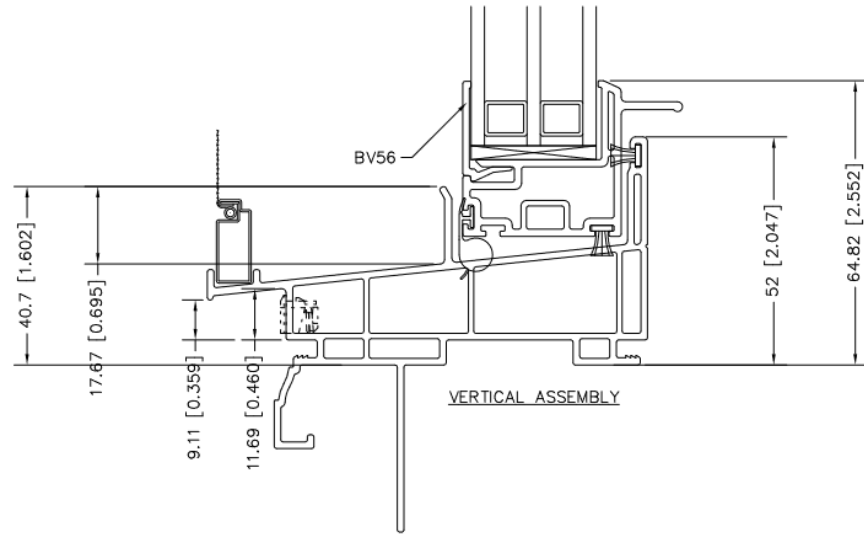
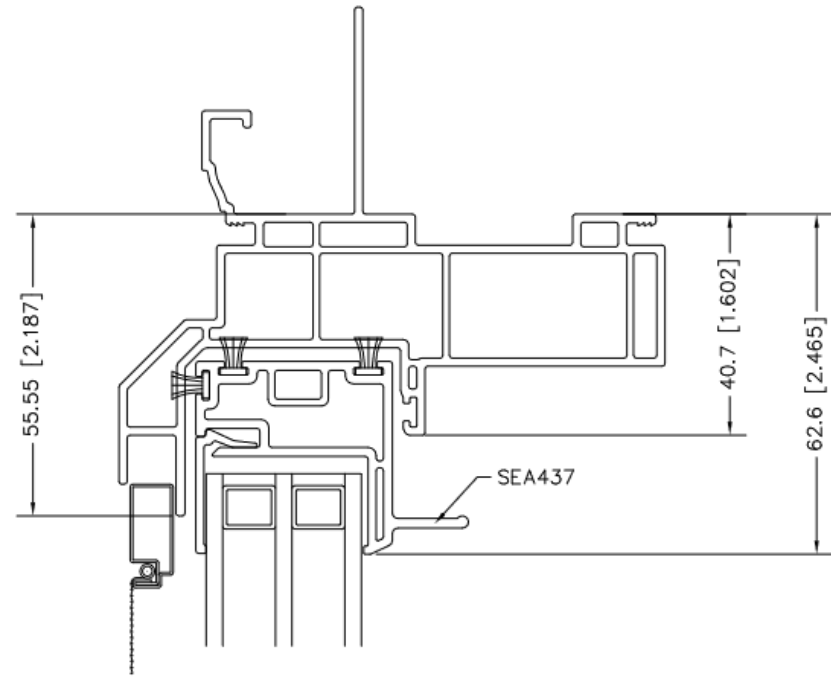



- Egress for New Construction

- Traditional top liftrail version will allow egress at a minimum size of 37x60-1/2

- Dedicated Egress window with liftrail removed will allow egress at a minimum size of 36 x 60

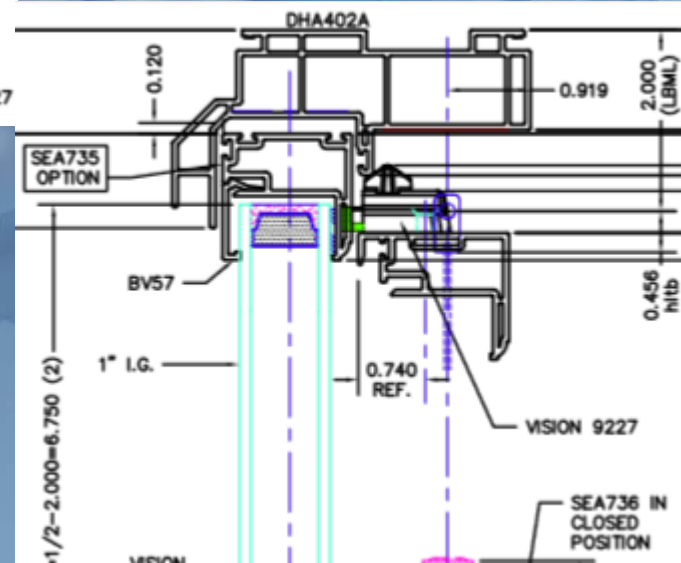
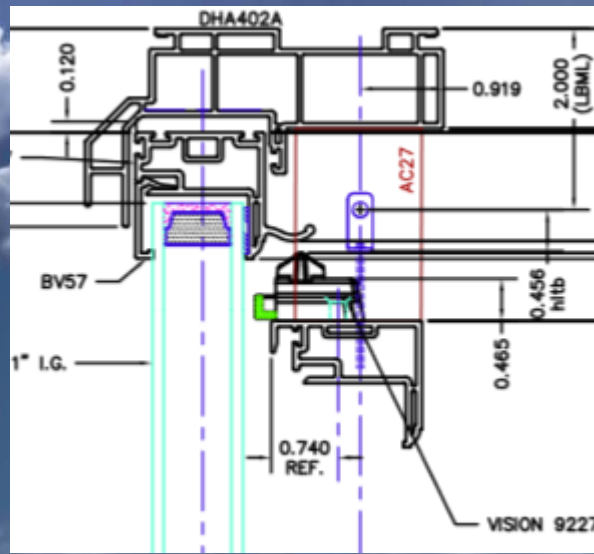

NOTE: Egress using Constant force resulted in slightly larger Egress sizes ie. 33.5 x 66.5



# Sash Design

- Meeting Rail Detail
- Unequal or Equal Glass Configurations
- Triple weather seal at meeting rail
- Glazing from  $\frac{3}{4}$ " to 1-1/8"
- Chamber in Lockrail hollow for lock attachment
- Fully enclosed pivot bar cavity
- Traditional Interlock design





## Ecolutions Decorative Equal Glass Option

- Equal glass option provides a distinct set of new sashes that work in Unequal glass tooling
- Equal Glass version uses detail on glazing leg to create unique appearance
- Equal glass version will allow all Ecolutions glazing and hardware options

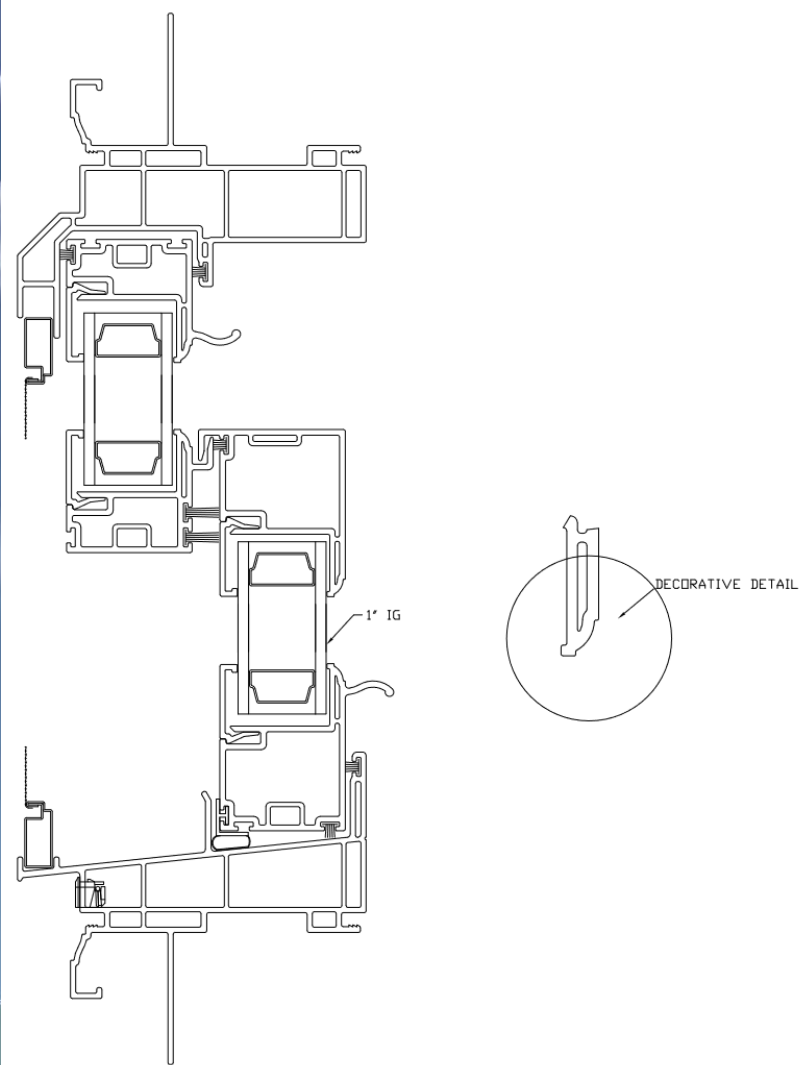



- Double Slider , and Picture Window

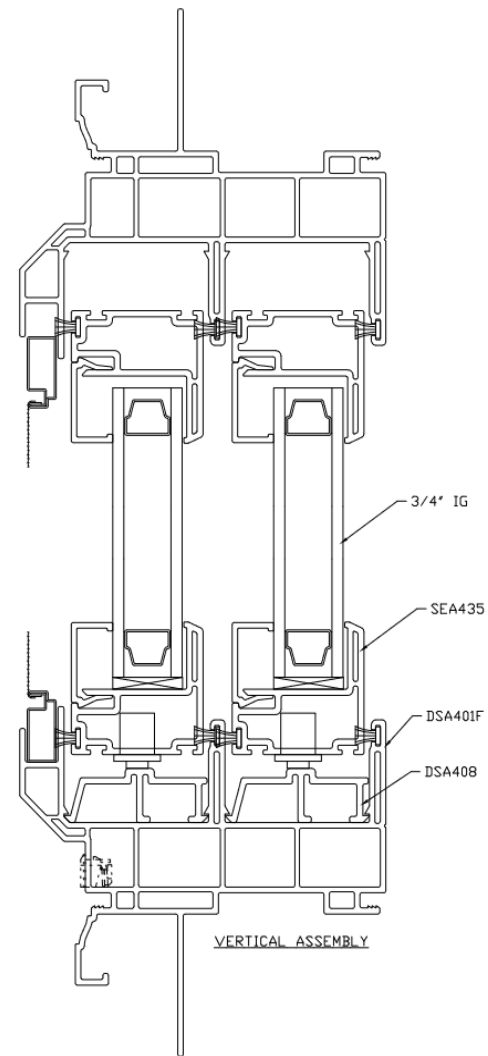
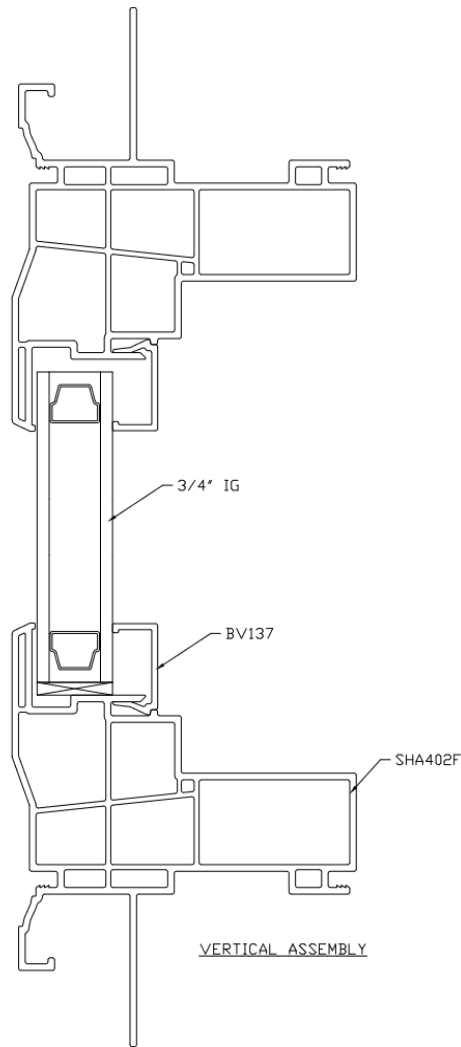

**Eco**olutions™

PW Master Frame  
Fin and No Fin

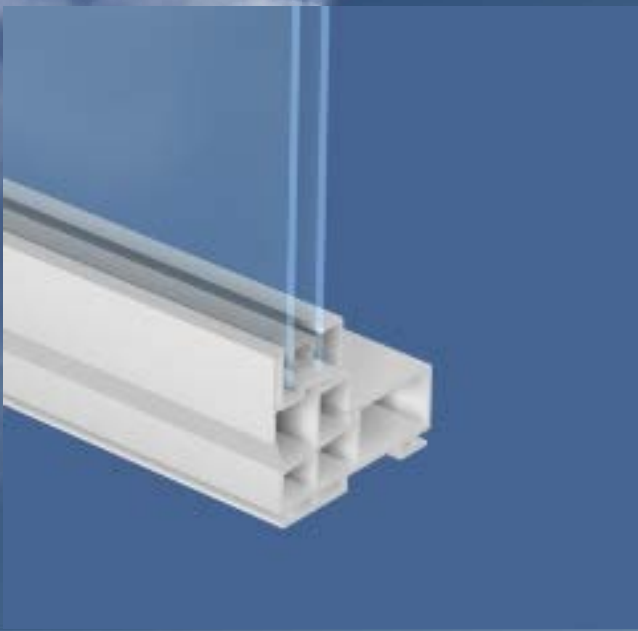



Double Slider  
Exterior View





## Double Slider Interior View

R-PG30 @63 x 44

Impact Tested@ 75x48

- R-PG50
- Un-Equal Glass
- Outboard Sash Fixed to Frame







# Single Hung

DP50 capability  
Enhanced Thermal Capability using  
Ecolutions 1-1/8" glass package  
(ideal for STC opportunities)

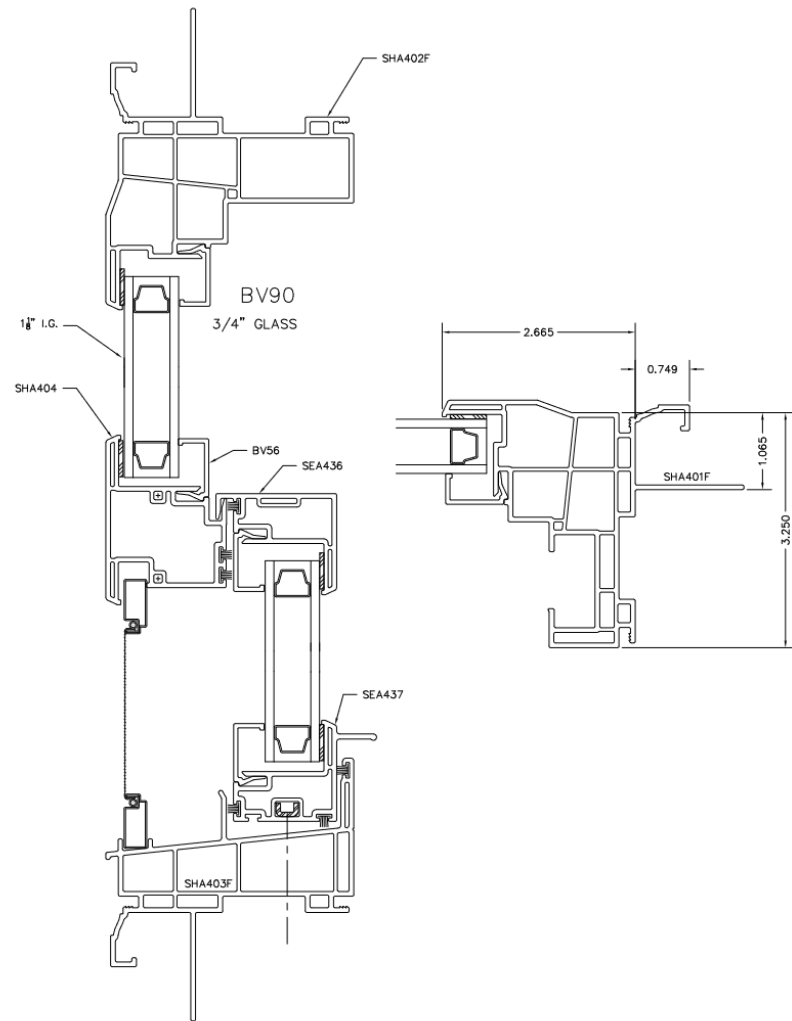

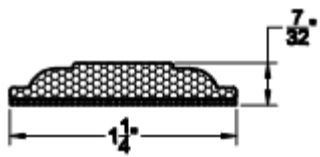

# Simulated Divided Lites

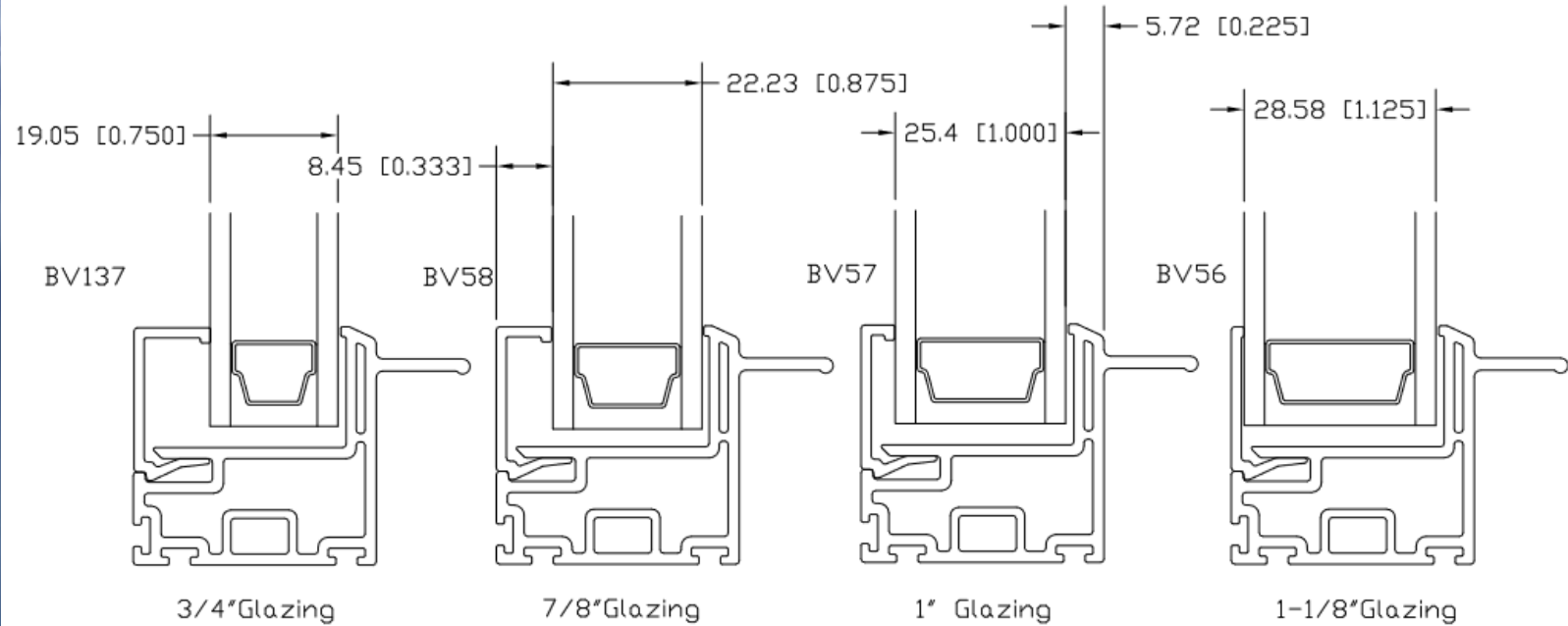
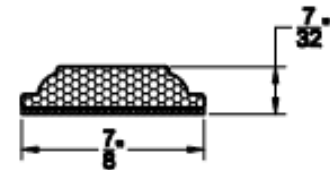

Ideal SDL applications for 1" and 7/8" IG.

7/32" SDL = .218".

# Reinforcement Options

## REINFORCEMENTS

### ALUMINUM

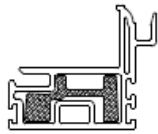

RF SEA434 A0M  
KEEPER RAIL  
SEA734

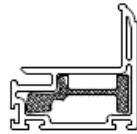

COMMON SASH  
SEA735

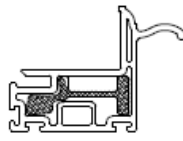

RF SEA745 A0 M  
HANDLE RAIL  
SEA737

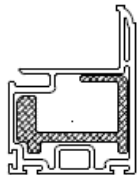

RF SEA745 A0 M  
COMMON SASH  
SEA745

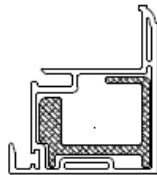

RF SEA746 A0 M  
LOCK RAIL SEA746

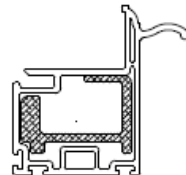

RF SEA745 A0 M  
HANDLE RAIL  
SEA747

### STEEL

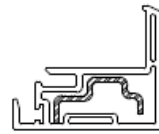

RF 3001 S0 M  
LOCK RAIL SEA436

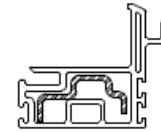

RF 3001 S0 M  
KEEPER RAIL  
SEA434

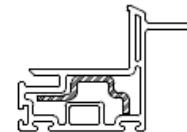

RF SE3435 S0 M  
HANDLE RAIL  
SEA437

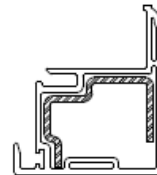

RF 3001 S0M

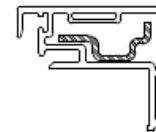

RF SE3435 S0 M  
LOCK RAIL SEA736

# INNERGY®

Rigid Thermal Reinforcements

Innergy® Rigid Thermal Reinforcements are advanced fiber glass reinforced resin inserts developed by Decuninck. VEKA is now an exclusive distributor for its own window and door profiles in North America.

• Innergy® Rigid Thermal Reinforcements are advanced fiber glass reinforced polyurethane resin inserts, precisely designed to slide easily into your window and door frames during fabrication.

• Innergy® can be designed to provide the structural strength of aluminum with the energy efficiency of a fiber glass resin that has low heat transfer.

• Innergy® is made from Bayer MaterialScience® polyurethane products.

• Innergy® is green to remind consumers – the product starts with an up to 20-percent bio-based resin component in its proprietary formulation.

• Innergy® helps protect against condensation and eliminates staining that can occur with metal reinforcements.



## Exclusive VEKA Profile Shapes



The information contained within is current at the time of printing. All window profile shapes are exclusive property of VEKA Inc. Please consult your VEKA sales representative for more information regarding this program. VEKA Inc. Copyright © 2013 VEKA Inc.® All Rights Reserved. Made in the USA.

Innergy® is a registered trademark of Decuninck North America. The color GREEN is a trademark of Decuninck North America LLC.

**INNERGY®** By **VEKA**  
Rigid Thermal Reinforcements



Science For A Better Life

# Sash Infill – Pultruded Fiberglass



**Natural Oak** *Interior*



**Cavalier Oak** *Interior*



**Golden Oak**

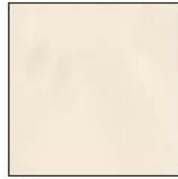

**Bone**

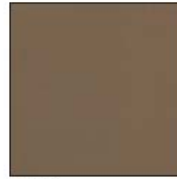

**Cocoa**



**Bronze**



**Hillside Oak** *Interior*



**Clay**



**Walnut**



**American Cherry** *Interior*



**Brushed Silver**



**Sand**



**Colonial Cherry** *Interior*



**Brown**



**Mahogany**



**American Maple** *Interior*



**Hunter Green**



**Dark Sapphire**



**Yellow Pine** *Interior*



**Rojo Oak**



**Chestnut**



**White**

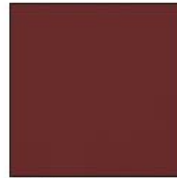

**Garnet**

*Interior = Applicable for the interior of the window only  
All others are available for both interior and exterior*

# Interior and Exterior Foil Lamination

# Available Locking Hardware



Face Applied Keeper



Traditional Cam Lock

# Available Locking Hardware



Vision Lock/Tilt Combo



# Available Locking Hardware



Lawrence Robo Tilt





Testing

Structural and Thermal

**SUMMARY OF RESULTS**

DP50 with no  
Refo and DSB

Summary of Results		
Title	Test Specimen #1 <i>Reinforced with 1/8" glass</i>	Test Specimen #2 <i>Non reinforced with 1/8" glass</i>
AAMA/WDMA/CSA 101/I.S.2/A440-08 and 11 Rating	Class R-PG30 1219 x 1829 (48 x 72) - H	Class R-PG50 1016 x 1600 (40 x 63) - H
Design Pressure	±1440 Pa (±30.08 psf)	±2400 Pa (±50.13 psf)
Air Infiltration	0.5 L/s/m <sup>2</sup> (0.09 cfm/ft <sup>2</sup> )	0.6 L/s/m <sup>2</sup> (0.12 cfm/ft <sup>2</sup> )
Water Penetration Resistance Test Pressure	260 Pa (5.43 psf)	360 Pa (7.52 psf)

Test Completion Date: 11/10/14

**SUMMARY OF RESULTS**

DP45 with no  
Refo and SSB

Summary of Results		
Title	Test Specimen #1 <i>Reinforced with 1/8" glass</i>	Test Specimen #2 <i>Non reinforced with 3/32" glass</i>
AAMA/WDMA/CSA 101/I.S.2/A440-08 and 11 Rating	Class R-PG30 1219 x 1829 (48 x 72) - H	Class R-PG45 1016 x 1600 (40 x 63) - H
Design Pressure	±1440 Pa (±30.08 psf)	±2160 Pa (±45.11 psf)
Air Infiltration	0.5 L/s/m <sup>2</sup> (0.09 cfm/ft <sup>2</sup> )	0.6 L/s/m <sup>2</sup> (0.12 cfm/ft <sup>2</sup> )
Water Penetration Resistance Test Pressure	260 Pa (5.43 psf)	360 Pa (7.52 psf)

## TEST REPORT

Report No.: E3213.01-501-47

Rendered to:

VEKA INC.  
Fombell, Pennsylvania.06cfm/ft<sup>2</sup>PRODUCT TYPE: PVC Double Hung Window  
SERIES/MODEL: DHA4WWSPECIFICATION(S): AAMA/WDMA/CSA 101/LS.2/A440-11, NAFS 2011 - North American  
Fenestration Standard/Specification for Windows, Doors, and SkylightsAAMA/WDMA/CSA 101/LS.2/A440-08, NAFS - North American Fenestration  
Standard/Specification for Windows, Doors, and Skylights

Title	Summary of Results
AAMA/WDMA/CSA 101/LS.2/A440-08 and -11	Class R-PG30 1219 x 1829 (48 x 72) - H
Design Pressure	±1440 Pa (±30.08 psf)
Air Infiltration	0.5 L/s/m <sup>2</sup> (0.06 cfm/ft <sup>2</sup> )
Water Penetration Resistance Test Pressure	260 Pa (5.43 psf)

Test Completion Date: 11/24/14

## TEST REPORT

Report No.: F1359.01-501-47

Rendered to:

VEKA INC.  
Fombell, PennsylvaniaLC50 Rating  
at 44 x 76PRODUCT TYPE: PVC Double Hung Window  
SERIES/MODEL: DHA4WWSPECIFICATION(S): AAMA/WDMA/CSA 101/LS.2/A440-11, NAFS 2011 - North American  
Fenestration Standard/Specification for Windows, Doors, and SkylightsAAMA/WDMA/CSA 101/LS.2/A440-08, NAFS - North American Fenestration  
Standard/Specification for Windows, Doors, and Skylights

Title	Summary of Results
AAMA/WDMA/CSA 101/LS.2/A440-08 and -11	Class LC-PG50 1118 x 1930 (44 x 76) - H
Design Pressure	±2400 Pa (±50.13 psf)
Air Infiltration	0.7 L/s/m <sup>2</sup> (0.13 cfm/ft <sup>2</sup> )
Canadian Air Infiltration/Exfiltration Level	A2
Water Penetration Resistance Test Pressure	360 Pa (7.52 psf)

Test Completion Date: 09/15/15



# Double Hung Impact/LC50

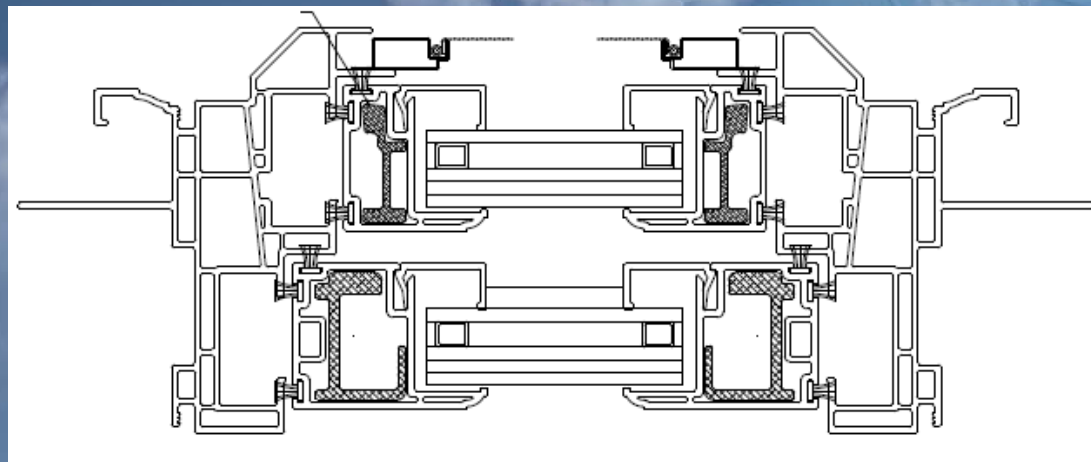
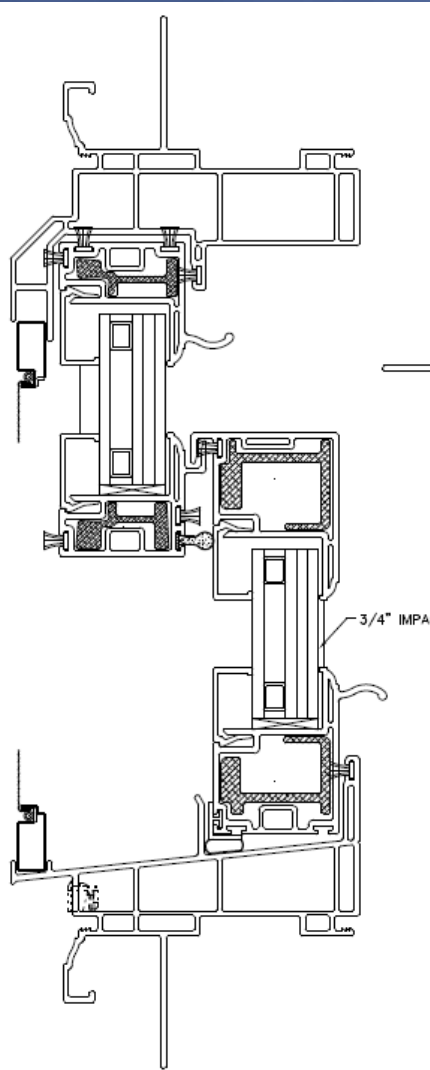

# AAMA 506 TEST REPORT

Report No.: F4526.01-501-47

Rendered to:

VEKA INC.  
Fombell, Pennsylvania

**PRODUCT TYPE:** PVC Double Hung Window  
**SERIES/MODEL:** DHA4WW

## 3.0 Project Summary:

3.1 **Product Type:** PVC Double Hung Window

3.2 **Series/Model:** DHA4WW

3.3 **Compliance Statement:** Results obtained are tested values and were secured by using the designated test method(s). The specimen(s) tested met the performance requirements set forth in the referenced test procedures for a  $\pm 2400$  Pa ( $\pm 50.13$  psf) Design Pressure with missile impacts corresponding to Missile Level D and Wind Zone

3.

3.4 **Test Date:** 01/06/16

3.5 **Test Record Retention End Date:** All test records for this report will be retained until January 6, 2020.

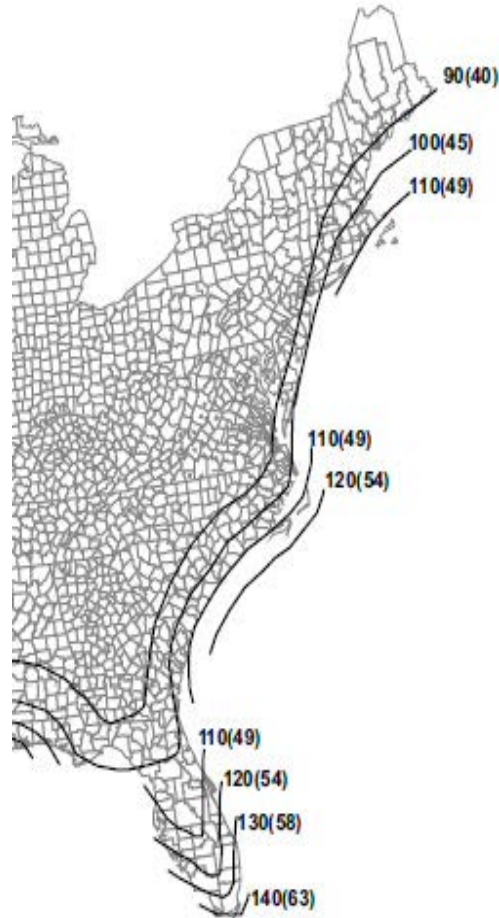

## Impact Missile Requirements

Missile Level	Missile	Impact Speed feet/sec (mph)	Typical Use
A	2 gram steel balls	130 (89)	Above 30 ft Wind Zone 1 through 4
B	2 lb. Lumber	50 (34)	Skylights < 30 ft. Wind Zone 2 (Basic)
C	4.5 lb. Lumber	40 (27)	Less than 30 ft. Wind Zone 1 & 2 (Basic)
D	9 lb. Lumber	50 (34)	Less than 30 ft. Wind Zone 3 & 4 (Basic) Wind Zone 1 & 2 (Enhanced)
E	9 lb. Lumber	80 (55)	Less than 30 ft. Wind Zone 3 & 4 (Enhanced)

Wind Zone 1 - 110mph  
Wind Zone 2 - 120mph  
Wind Zone 3 - 130mph  
Wind Zone 4 - 140mph

## DHA4WW R and D Thermal Results 8-5-14

Window System	Sash	IG	Air Space	Refo	Spacer	Total U-Factor Btu/h-ft <sup>2</sup> -f	SHGC	VT	Dividers
DHA4WW	SEA4	3/4" clr/arg90/CS63 SSB	0.563 ARG90	steel	Duralite	0.2831	0.5025	0.6292	No
DHA4WW	SEA4	3/4" clr/arg95/CS63 SSB	0.563 ARG95	steel	Duralite	0.2809	0.5026	0.6292	No
DHA4WW	SEA4	3/4" clr/arg90/CS63 SSB	0.563 ARG90	Fiberglass	Duralite	0.2820	0.5024	0.6292	No
DHA4WW	SEA4	3/4" clr/arg95/CS63 SSB	0.563 ARG95	Fiberglass	Duralite	0.2799	0.5026	0.6292	No
DHA4WW	SEA4	1-1/8" CS63/arg90/clr/arg90/CS63 SSB	0.437 ARG90	steel	Duralite	0.1825	0.3965	0.5563	No
DHA4WW	SEA4	1-1/8" CS63/arg95/clr/arg95/CS63 SSB	0.437 ARG95	steel	Duralite	0.1809	0.3965	0.5562	No
DHA4WW	SEA4	1-1/8" CS63/arg90/clr/arg90/CS63 SSB	0.437 ARG90	Fiberglass	Duralite	0.1815	0.3964	0.5562	No
DHA4WW	SEA4	1-1/8" CS63/arg95/clr/arg95/CS63 SSB	0.437 ARG95	Fiberglass	Duralite	0.1798	0.3964	0.5562	No
DHA4WW	SEA4	3/4" clr/arg90/CS36 SSB	0.563 ARG90	steel	Duralite	0.2730	0.3901	0.5263	No
DHA4WW	SEA4	3/4" clr/arg95/CS36 SSB	0.563 ARG95	steel	Duralite	0.2708	0.3903	0.5263	No
DHA4WW	SEA4	3/4" clr/arg90/CS36 SSB	0.563 ARG90	Fiberglass	Duralite	0.2720	0.3900	0.5263	No
DHA4WW	SEA4	3/4" clr/arg95/CS36 SSB	0.563 ARG95	Fiberglass	Duralite	0.2697	0.3903	0.5263	No
DHA4WW	SEA4	1-1/8" CS36/arg90/clr/arg90/CS36 SSB	0.437 ARG90	steel	Duralite	0.1750	0.2465	0.3917	No
DHA4WW	SEA4	1-1/8" CS36/arg95/clr/arg95/CS36 SSB	0.437 ARG95	steel	Duralite	0.1734	0.2465	0.3917	No
DHA4WW	SEA4	1-1/8" CS36/arg90/clr/arg90/CS36 SSB	0.437 ARG90	Fiberglass	Duralite	0.1740	0.2465	0.3917	No
DHA4WW	SEA4	1-1/8" CS36/arg95/clr/arg95/CS36 SSB	0.437 ARG95	Fiberglass	Duralite	0.1723	0.2465	0.3917	No

\*\* The above results are for R and D purposes only. For official results, simulations must be done by an Independent Accredited Lab.

**DHA4WW R and D Thermal Results 8-17-15**

<b>Window System</b>	<b>Sash</b>	<b>IG</b>	<b>Air Space</b>	<b>Refo</b>	<b>Spacer</b>	<b>Total U-Factor Btu/h-ft<sup>2</sup>-f</b>	<b>SHGC</b>	<b>VT</b>	<b>Dividers</b>
DHA4WW	SEA4	3/4" clr/arg90/366 DSB	0.500 ARG90	none	Duralite	0.2670	0.3020	0.5000	No
DHA4WW	SEA4	3/4" clr/arg95/366 DSB	0.500 ARG95	none	Duralite	0.2640	0.3030	0.5000	No
DHA4WW	SEA4	7/8" clr/arg90/366 DSB	0.625 ARG90	none	Duralite	0.2710	0.3040	0.5000	No
DHA4WW	SEA4	7/8" clr/arg95/366 DSB	0.625 ARG95	none	Duralite	0.2690	0.3040	0.5000	No

# Accessory Options

- Flat Casing Options
- Brickmould Options
- Sheetrock Return
- Jamb extensions
- Mulling
- Mulling Accessories



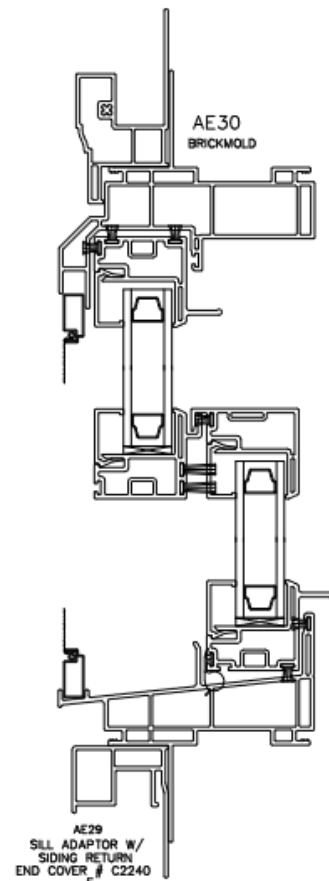
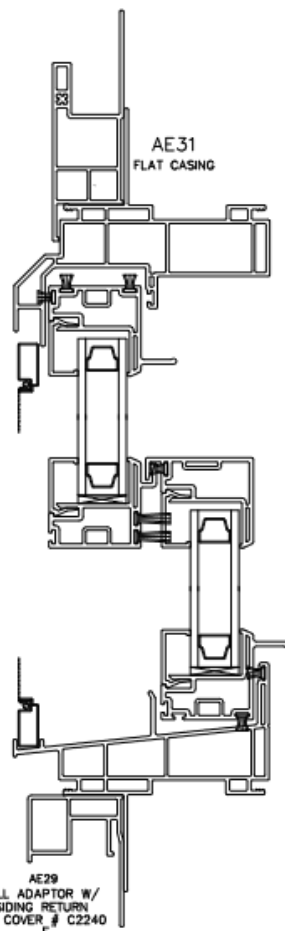
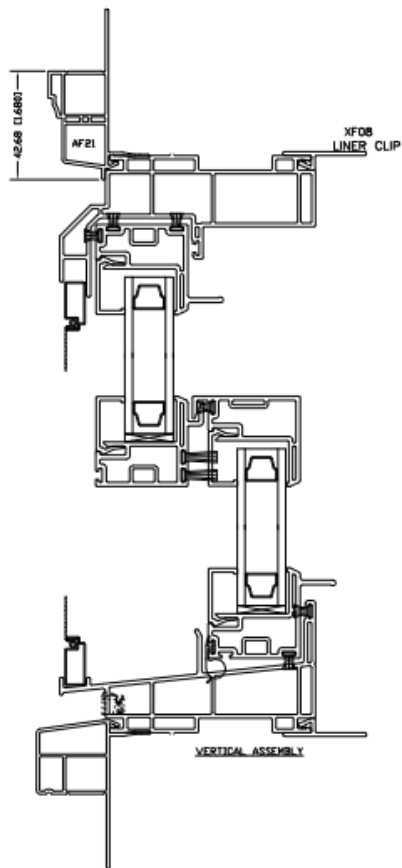
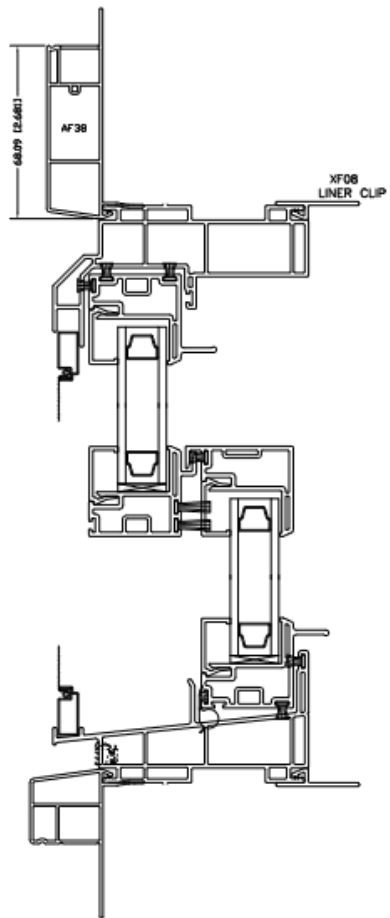

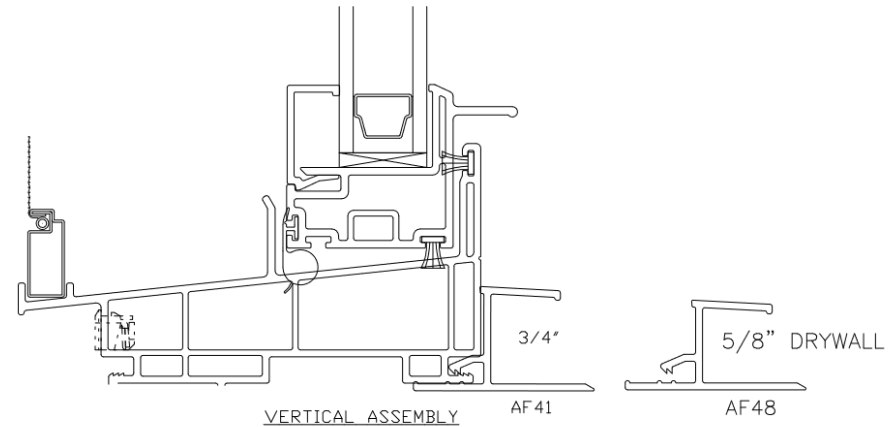
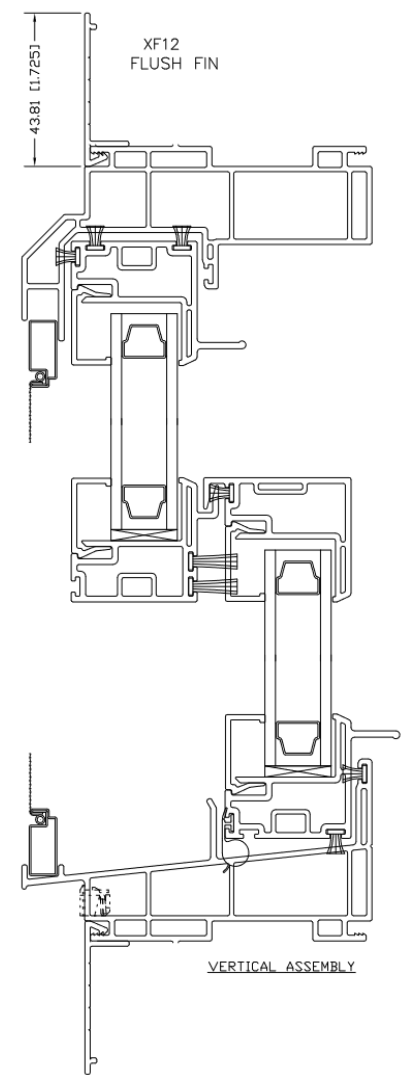
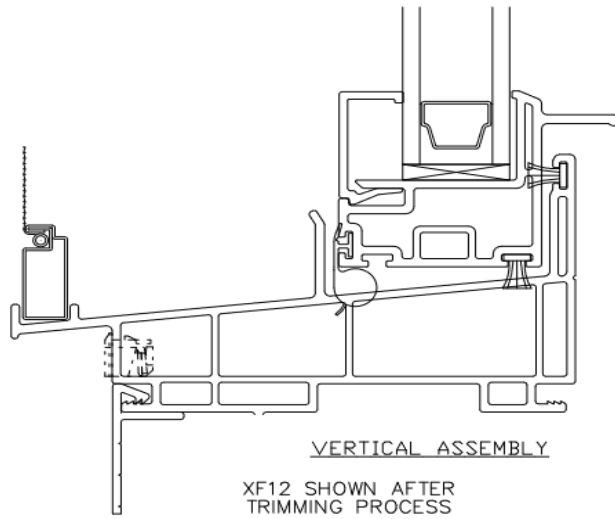
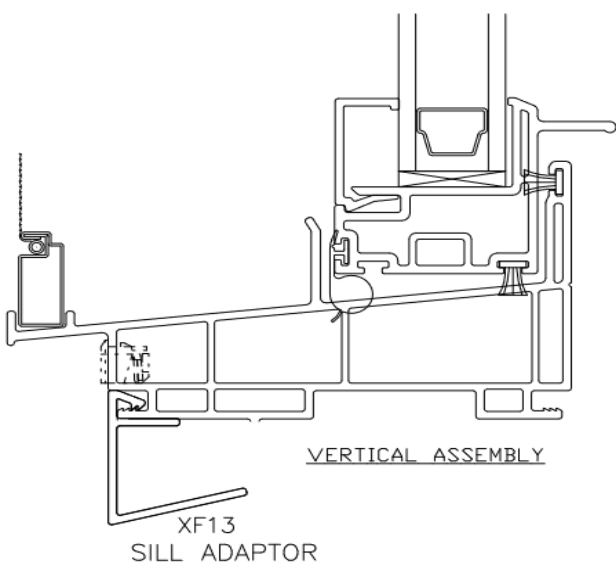

Additional  
Accessory  
Profiles

# Standard Mulling Configurations and Mulling Accessories

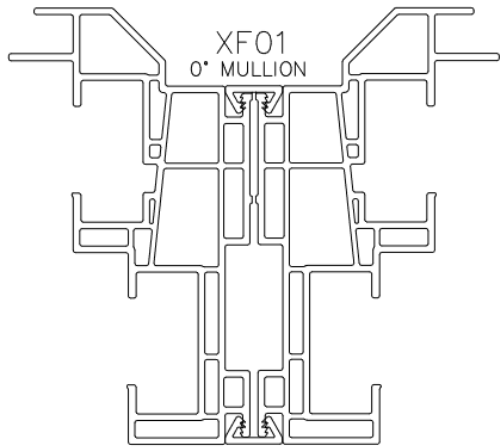

\*

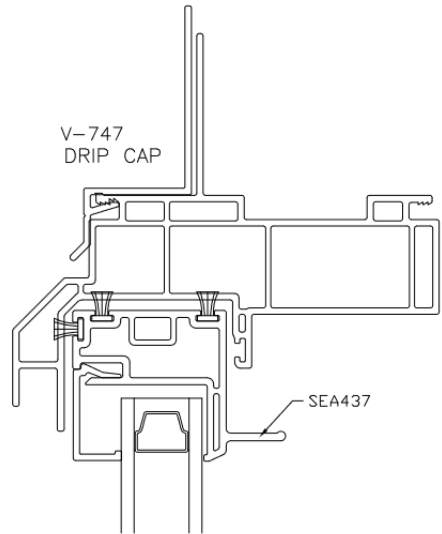
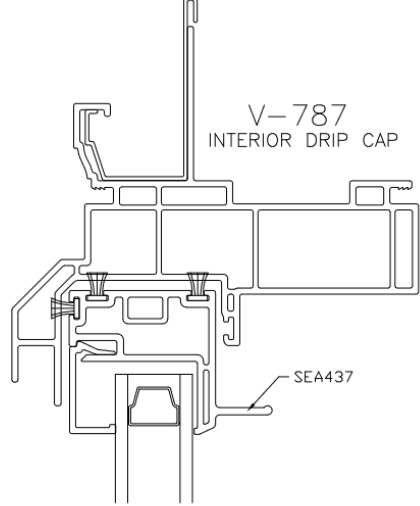
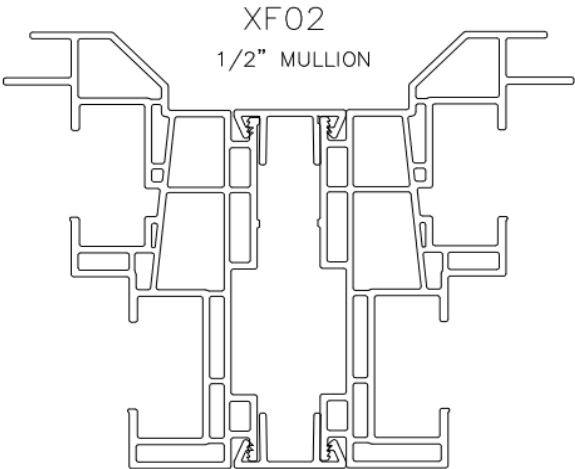

# Complementary Casement RR

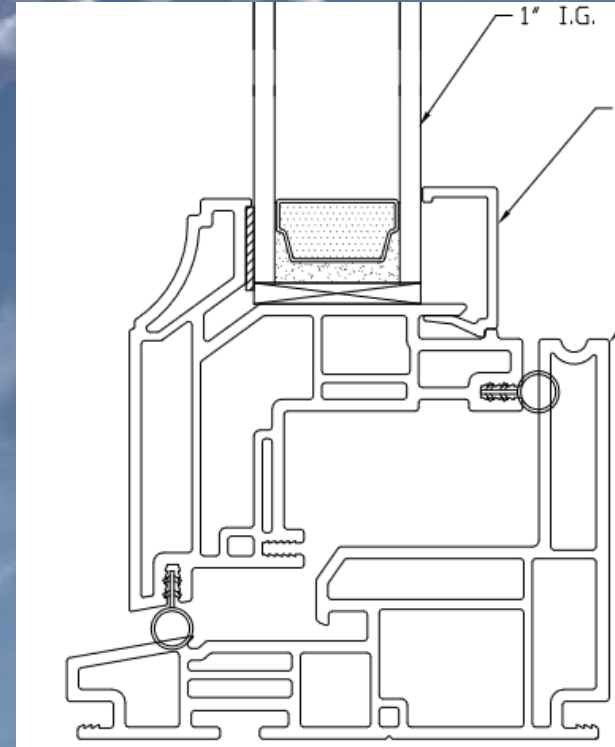
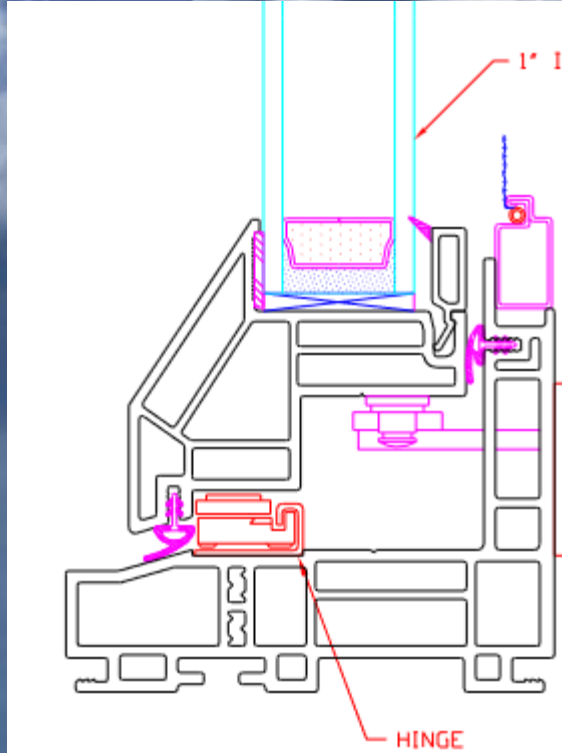

# Complementary Casement NC

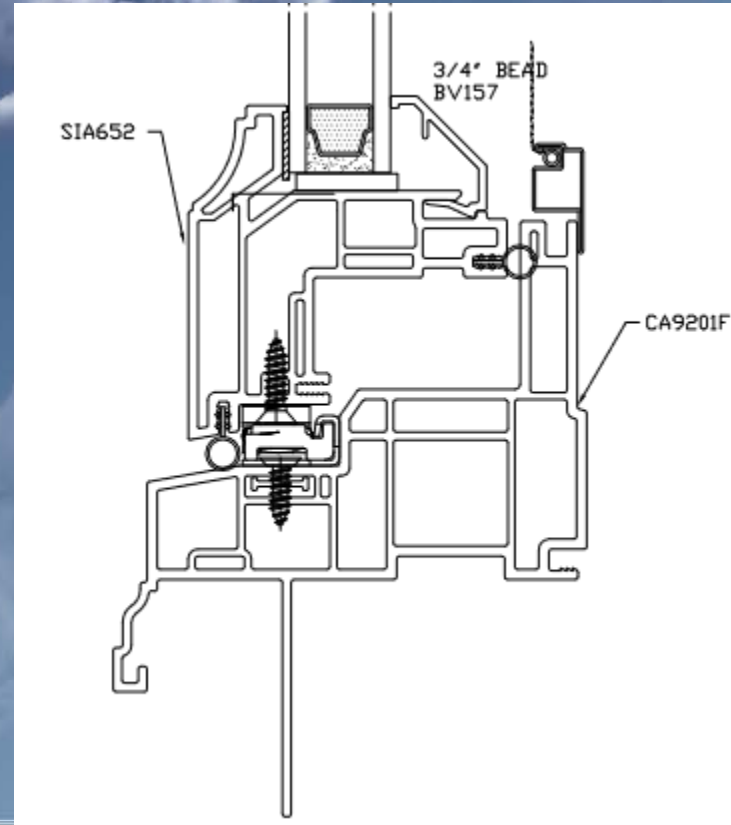
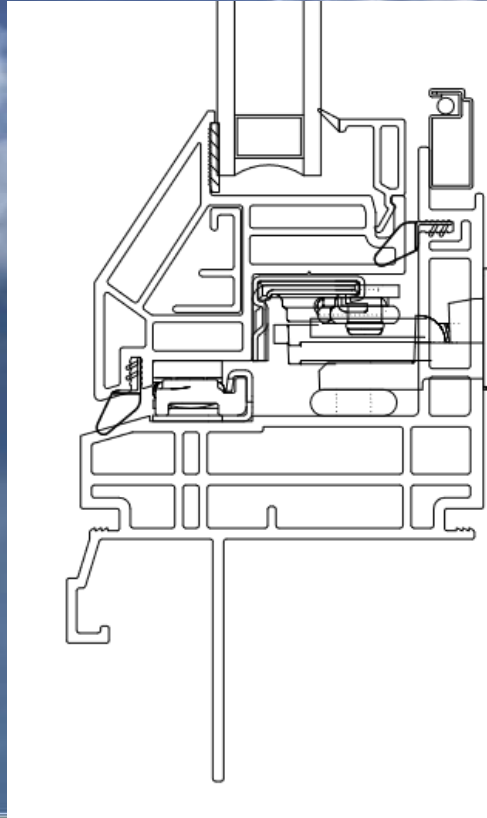



Thank You

**Eco**olutions™